



**Metcalfe Mtungwazi**  
062 676 2638  
metcalfe.mtungwazi@archonint.com

Contact Archon International  
Properties Johannesburg

011 568 4341

Ground Floor  
The Place  
1 Sandton Drive  
Sandton  
2196

FEATURED

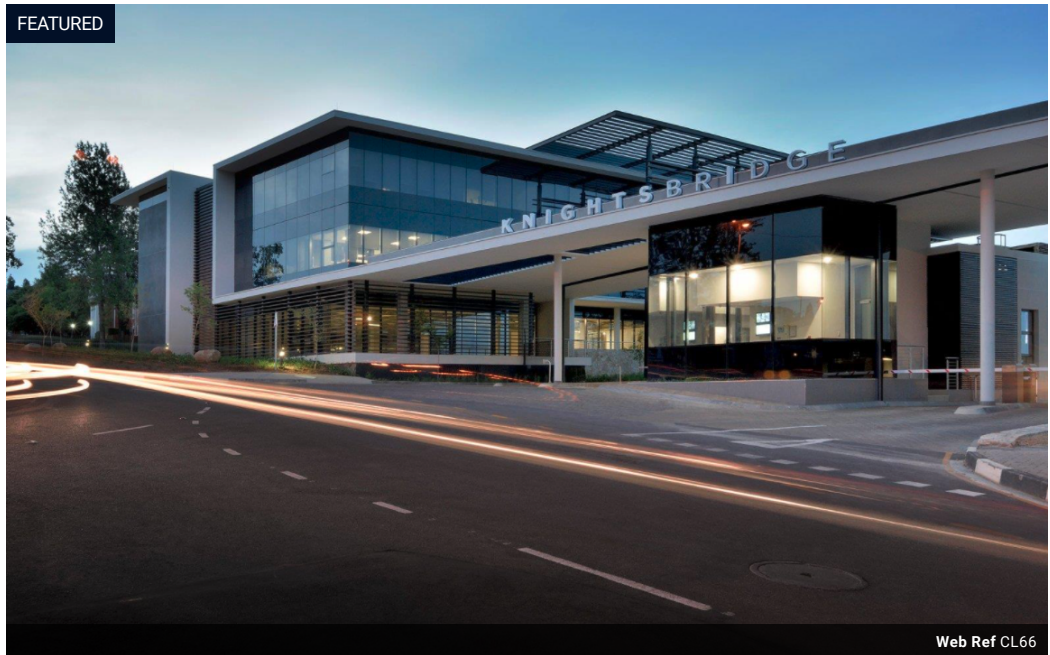

Web Ref CL66



R190 per m<sup>2</sup>

Gross Monthly Rental R586,340 Excl. VAT



### KNIGHTSBRIDGE OFFICE PARK

P Grade office development opportunities measuring from 3086sqm to 7000sqm in the high end commercial hub of Bryanston

Knightsbridge Development is a redevelopment office park, based in Bryanston, Johannesburg. This prime located office development will boast 29 352sqm in terms of GLA office space. The Knightsbridge development, location in Sloane Street opposite the Didata Campus, Started in November 2015 and the first of seven new Buildings was completed in May 2017

The new Knightsbridge is a P-grade, resource-efficient and green rated office complex and the entire office park is designed to achieve a 4-star Green Star SA rating. Bryanston is a growing business hub, therefore, Knightsbridge development responds to the

### Features

**Zoning** Commercial

**Sizes**  
Floor Size 3,086m<sup>2</sup>

