



Metcalfe Mtungwazi
062 676 2638
metcalfe.mtungwazi@archonint.com

Contact Archon International
Properties Johannesburg

011 568 4341

Ground Floor
The Place
1 Sandton Drive
Sandton
2196



Web Ref CL46

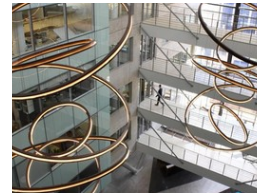
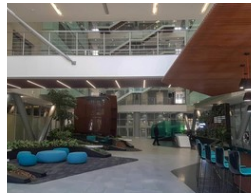

R165 per m²

Gross Monthly Rental R131,010 Excl. VAT

0 0

Unlock the potential of space | Sandown, Johannesburg

This building comprises 11 000 square meters of office space that sits atop a 4 level parking podium. This gives the building a commanding presence, which is reinforced by the distinctive V-shaped columns on the West Street ground floor edge.

The communal spaces are completed by new meeting room and workspace areas, along with a new Seattle Coffee Bar, which are for the exclusive use of the tenants.

The linking bridges between the floor plates allow for flexibility and ease of orientation for day-to-day circulation. With a coffee bar that is committed to providing a plentiful mix of nutritious food choices and glass surfaces that are designed to capture the dramatic Joburg sky, this is the perfect multifunctional

Features

Zoning Commercial

Interior

Air Conditioning Yes
Power 3 Phase Yes

Exterior

Security Yes
Parking Ratio 4 bays / 100 m²

Sizes

Floor Size 794m²

Extras

Generator and Water Backup

